

# LICENSING ACT 2003

## PREMISES LICENCE



**Cherwell**  
DISTRICT COUNCIL  
NORTH OXFORDSHIRE

### PART A – Part 1

<b>The White Hart</b> <b>4 Sheep Street</b> <b>Bicester</b> <b>OX26 6TB</b>	<b>Licence Ref:</b>	PRM0233
	<b>Date Granted:</b>	21.04.2020
	<b>Valid from:</b> <b>Valid to:</b>	Not Time Limited
	<b>Issue date:</b>	21.04.2020
	<b>Tel No.:</b>	

<b>Premises Licence Holder</b>	<b>Greene King Brewing And Retailing Limited</b> <b>Westgate Brewery</b> <b>Bury St Edmunds</b> <b>Suffolk</b> <b>IP33 1QT</b>
--------------------------------	--

### Licensable Activities - Alcohol Sales

Activity	Days of Week	Open	Close
<b>Sale of Alcohol</b> <b>Alcohol is supplied for consumption both on and off the Premises</b>	Thursday	10:00	02:00
<b>Sale of Alcohol</b> <b>Alcohol is supplied for consumption both on and off the Premises</b>	Sunday to Thursday	10:00	01:00
<b>Sale of Alcohol</b> <b>Alcohol is supplied for consumption both on and off the Premises</b>	Friday and Saturday	10:00	03:00

### Licensable Activities - Other

Activity	Days of Week	Open	Close
<b>Late Night Refreshment (Indoors)</b>	Sunday	23:00	01:00
<b>Late Night Refreshment (Indoors)</b>	Friday and Saturday	23:00	03:00
<b>Late Night Refreshment (Indoors)</b>	Monday to Thursday	23:00	02:00
<b>Regulated Entertainment (Indoors)</b>	Sunday	10:00	01:30
<b>Regulated Entertainment (Indoors)</b>	Friday and Saturday	10:00	03:30

<b>Regulated Entertainment (Indoors)</b>	Monday to Wednesday	10:00	01:00
--	---------------------	-------	-------

### **Seasonal Variations**

**Late Night Refreshment** On St Davids Day, St Patricks Day, St Georges Day, St Andrews, Day the finish time will be extended by 1 hour, with 7 days notice and agreement with the Police.

For statutory Bank Holiday weekend periods (Friday, Saturday, Sunday and Monday) and for the Thursday before Good Friday and for Christmas Eve, the finish time will be extended by 1 hour beyond these times. On occasions of local, national or international significance or for charitable events, limited to 12 per year, the finish time will be extended by 1 hour, with 14 days notice and agreement with the Police.

**Regulated Entertainment** On St Davids Day, St Patricks Day, St Georges Day, St Andrews, Day the finish time will be extended by 1 hour, with 7 days notice and agreement with the Police.

For statutory Bank Holiday weekend periods (Friday, Saturday, Sunday and Monday) and for the Thursday before Good Friday and for Christmas Eve, the finish time will be extended by 1 hour beyond these times. On occasions of local, national or international significance or for charitable events, limited to 12 per year, the finish time will be extended by 1 hour, with 14 days notice and agreement with the Police.

**Sale of Alcohol** On St Davids Day, St Patricks Day, St Georges Day, St Andrews Day the finish time will be extended by 1 hour, with 7 days notice and agreement with the Police.

For statutory Bank Holiday weekend periods (Friday, Saturday, Sunday and Monday) and for the Thursday before Good Friday and for Christmas Eve, the finish time will be extended by 1 hour beyond these times. On occasions of local, national or international significance or for charitable events, limited to 12 per year, the finish time will be extended by 1 hour, with 14 days notice and agreement with the Police.

New Years Eve from the end of permitted hours on New Years Eve to the start of permitted hours on the following day (or, if there are no permitted hours on the following day, midnight on 31 December)

### **Opening Hours**

<b>Days of Week</b>	<b>Open</b>	<b>Close</b>
Friday and Saturday	09:00	03:30
Monday to Wednesday	09:00	02:00
Thursday	09:00	02:30
Sunday	09:00	01:30

### **Seasonal Variations**

On St Davids Day, St Patricks Day, St Georges Day, St Andrews, Day the finish time will be extended by 1 hour, with 7 days notice and agreement with the Police.

For statutory Bank Holiday weekend periods (Friday, Saturday, Sunday and Monday) and for the Thursday before Good Friday and for Christmas Eve, the finish time will be extended by 1 hour beyond these times. On occasions of local, national or international significance or for charitable events, limited to 12 per year, the finish time will be extended by 1 hour, with 14 days notice and agreement with the Police.

**PART A - Part 2**

**Registered number of holder, for example company number, charity number**

Registered Company Number 03298903

**Name of designated premises supervisor where the premises licence authorises for the supply of alcohol**

Mr John O'Leary  
The White Hart  
4 Sheep Street  
Bicester  
OX26 6TB

**Personal licence number and issuing authority of personal licence held by designated premises supervisor where the premises licence authorises for the supply of alcohol**

Licence Number: 05JO/00AQ/WGPD/LQYY  
Licensing Authority: London Borough Of Harrow



Michael Sands  
Licensing Officer  
21 April 2020



# Annex 1 – Mandatory conditions

## Mandatory Conditions

### All Premises Licence authorising supply of alcohol

The licence is granted subject to the Mandatory conditions for sale of alcohol as set out in the Licensing Act 2003 as amended by the Licensing Act 2003 (Mandatory Licensing Conditions) Order 2010 and Order 2014.

1. No Supply of alcohol may be made under the Premises Licence -
  - a) At a time when there is no Designated Premises Supervisor in respect of the Premises Licence; or
  - b) At a time when then the Designated Premises Supervisor does not hold a Personal Licence or his Personal Licence is suspended
2. Every supply of alcohol under the Premises Licence must be made, or authorised by a person who holds a Personal Licence
- 3.1 The responsible person must ensure that staff on relevant premises do not carry out, arrange or participate in any irresponsible promotions in relation to the premises
- 3.2 In this paragraph, an irresponsible promotion means any one or more of the following activities, or substantially similar activities, carried on for the purpose of encouraging the sale or supply of alcohol for consumption on the premises.
  - a) games or other activities which require or encourage, or are designed to require or encourage, individuals to -
    - i. drink a quantity of alcohol within a time limit (other than to drink alcohol sold or supplied on the premises before the cessation of the period in which the responsible person is authorised to sell or supply alcohol), or
    - ii. drink as much alcohol as possible (whether within a time limit or otherwise);
  - b) provision of unlimited or unspecified quantities of alcohol free or for a fixed or discounted fee to the public or to a group defined by a particular characteristic in a manner which carries a significant risk of undermining a licensing objective;
  - c) provision of free or discounted alcohol or any other thing as a prize to encourage or reward the purchase and consumption of alcohol over a period of 24 hours or less in a manner which carries a significant risk of undermining a licensing objective;
  - d) selling or supplying alcohol in association with promotional posters or flyers on, or in the vicinity of, the premises which can reasonably be considered to condone, encourage or glamorise anti-social behaviour or to refer to the effects of drunkenness in any favourable manner.
  - e) dispensing alcohol directly by one person into the mouth of another (other than where that other person is unable to drink without assistance by reason of disability).
4. The responsible person must ensure that free potable water is provided on request to customers where it is reasonably available
- 5.1 The premises licence holder or club premises certificate holder must ensure that an age verification policy is adopted in respect of the premises in relation to the sale or supply of alcohol.
- 5.2 The designated premises supervisor in relation to the premises licences must ensure that the supply of alcohol at the premises is carried on in accordance with the age verification policy.
- 5.3 The policy must require individuals who appear to the responsible person to be under 18 years of age (or such older age as may be specified in the policy) to produce on request, before being served alcohol, identification bearing their photograph, date of birth and either:-
  - a. a holographic mark or
  - b. an ultraviolet feature
6. The responsible person must ensure that -
  - a) where any of the following alcoholic drinks is sold or supplied for consumption on the premises (other than alcoholic drinks sold or supplied having been made up in advance ready for sale or supply in a securely closed container) it is available to customers in the following measures:-
    - i. beer or cider: ½ pint;
    - ii. gin, rum, vodka or whiskey: 25ml or 35ml; and
    - iii. still wine in a glass: 125ml; and

- b) these measures are displayed in a menu, price list or other printed material which is available to customers on the premises; and
- c) where a customer does not in relation to a sale of alcohol specify the quantity of alcohol to be sold, the customer is made aware that these measures are available.

#### Minimum Drinks Pricing

- 1. A relevant person shall ensure that no alcohol is sold or supplied for consumption on or off the premises for a price which is less than the permitted price
- 2. For the purposes of the condition set out in paragraph 1 -
  - a. "duty" is to be construed in accordance with the Alcoholic Liquor Duties Act 1979
  - b. "permitted price" is the price found by applying the formula -

$$P=D+(D \times V)$$

Where: -

- i. P is the permitted price
  - ii. D is the amount of duty chargeable in relation to the alcohol as if the duty were charged on the date of the sale or supply of alcohol, and
  - iii. V is the rate of value added tax chargeable in relation to the alcohol as if the value added tax were charged on the date of the sale or supply of alcohol;
- c. "relevant person" means, in relation to premises in respect of which there is in force a premises licence -
    - i. The holder of the premises licence
    - ii. The designated premises supervisor (if any) in respect of such a licence, or
    - iii. The personal licence holder who makes or authorises a supply of alcohol under such a licence;
  - d. "relevant person" means, in relation to premises in respect of which there is in force a club premises certificate, any member or officer of the club present on the premises in a capacity which enables the member or officer to prevent the supply in question; and
  - e. "value added tax" means value added tax charged in accordance with Value Added Tax Act 1994
3. Where the permitted price given by Paragraph (b) of paragraph 2 would (apart from the paragraph) not be a whole number of pennies, the price given by that sub-paragraph shall be taken to be the price actually given by that sub-paragraph rounded up to the nearest penny.

4.1 Sub-paragraph (2) applies where the permitted price given by Paragraph (b) of paragraph 2 on a day ("the first day") would be different from the permitted price on the next day ("the second day") as a result of a change to the rate of duty or value added tax

4.2 The permitted price which would apply on the first day applies to sales or supplies of alcohol which take place before the expiry of the period of 14 days beginning on the second day

#### If the Premises Licence allows Exhibition of Films

- 1. Where a premises licence authorises the exhibition of films, the licence must include a condition requiring the admission of children to the exhibition of any film to be restricted in accordance with this section.
- 2. Where the film classification body is specified in the licence, unless subsection (3)(b) applies, admission of children must be restricted in accordance with any recommendation by that body.

#### 3. Where

- (a) The film classification body is not specified in the licence, or
- (b) The relevant licensing authority has notified the holder of the licence that this subsection applies to the film in question,

admission of children must be restricted in accordance with any recommendation made by that licensing authority.

4. In this section "children" means any person aged under 18; and

"film classification body" means the person or persons designated as the authority under Section 4 of the Video Recordings Act 1984(c39) (authority to determine suitability of video works for classification).

If the Premises Licence has conditions in respect of Door Supervision except theatres, cinemas, bingo halls and casinos

1. Where a premises licence includes a condition that at specified times one or more individuals must be at the premises to carry out a security activity, each such individual must:

(a) be authorised to carry out that activity by a licence granted under the Private Security Industry Act 2001; or

(b) be entitled to carry out that activity by virtue of section 4 of the Act.

2. But nothing in subsection (1) requires such a condition to be imposed:

(a) in respect of premises within paragraph 8(3)(a) of Schedule 2 to the Private Security Industry Act 2001 (c12) (premises with premises licences authorising plays or films) ; or

(b) in respect of premises in relation to:

(i) any occasion mentioned in paragraph 8(3)(b) or (c) of that Schedule (premises being used exclusively by club with club premises certificate, under a temporary event notice authorising plays or films or under a gaming licence), or

(ii) any occasion within paragraph 8(3)(d) of that Schedule (occasions prescribed by regulations under that Act.

3. For the purposes of this section:

(a) "security activity" means an activity to which paragraph 2(1)(a) of that Schedule applies, and, which is licensable conduct for the purposes of that Act, (see Section 3(2) of that Act) and

(b) paragraph 8(5) of that Schedule (interpretation of references to an occasion) applies as it applies in relation to paragraph 8 of that Schedule.



## **Annex 2 – Conditions consistent with the operating schedule**

### **General - all four licensing objectives**

We have applied for an extended period between the cessation of the supply of alcohol and the closure of the premises to give us the option to allow for a more gradual dispersal of customers. The style and operation of the pub will not differ significantly during the extended hours. Where this is appropriate, non-alcoholic refreshment will be available in the extended period.

The premises will respect Spirit Group's Approach to Responsible Drinking (a copy of which was enclosed in support of this application). Our policies change at regular intervals to reflect current trends and it would be inappropriate to standardise them on a permanent basis. The enclosed policy is included for information only and not as suggested conditions or to form part of any other Operating Schedule.

### **The prevention of crime and disorder**

When door staff are used they will be Security Industry Authority (SIA) approved and operate in accordance with the security industry guidelines.

A zero tolerance towards illegal drugs will be enforced at all times.

If a disc jockey is used on any night then he/she will ask customers to leave quietly.

If a CCTV system is installed at this site, it will continue to operate during the additional hours of trading and notices will be displayed.

All instances of crime and disorder will be reported to the police and will be kept in an incident log book.

### **Public Safety**

Public safety is integral to the way that the Spirit Group runs its business and is reviewed regularly through our health and safety policy. This policy is fully briefed and trained to all management and staff and we will continue to train our staff to the standards required by relevant legislation. Free drinking water will be available at all times.

### **The prevention of public nuisance**

Additional patrols will take place by members of staff, internally and externally, to limit any noise pollution when entertainment is being offered within the premises.

If appropriate, notices will be displayed asking our customers to respect our neighbours when leaving the premises.

Where already used text/radio pagers will continue to be used for the additional hours of trading and will be monitored by a responsible member of staff.

Soft drinks and non-alcoholic refreshment will be available if we decide to use the option to stay open for an extended period between the cessation of the supply of alcohol and the closure of the premises (see above under General).

All external doors/windows must be kept closed other than for access and egress in all rooms when events involving amplified music or speech are taking place.

No licensable activities or consumption of alcohol will take place externally after 23:00.

### **The protection of children from harm**

When children are allowed upon the premises, any entertainment offered within the premises will be suitable for young persons. Children will be required to be supervised by the accompanying adult at all time.

Soft drinks and non-alcoholic drinks will be available. A recognised Proof of Age Policy will be enforced.

### Conditions Required by Committee

## Annex 4 – Plans

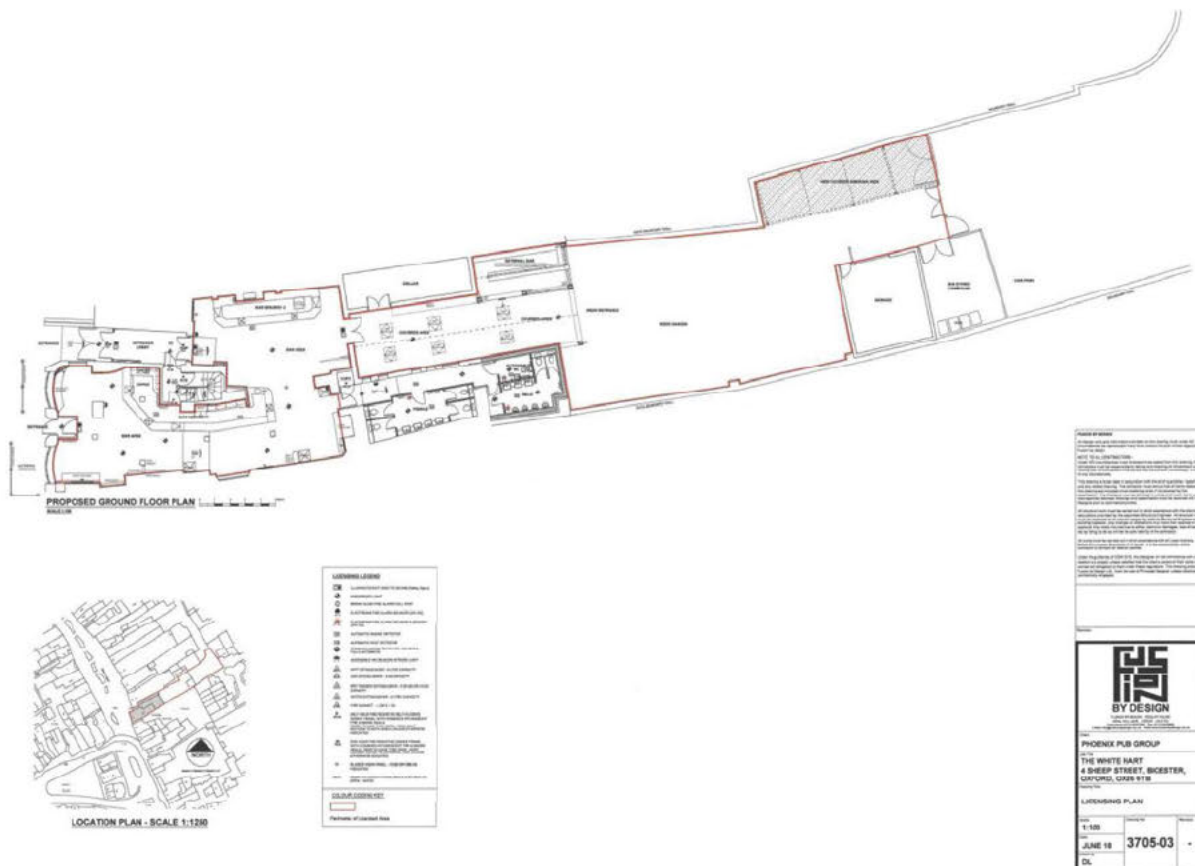



# LICENSING ACT 2003

## PREMISES LICENCE



**Cherwell**  
DISTRICT COUNCIL  
NORTH OXFORDSHIRE

### PART B

<b>The White Hart</b> <b>4 Sheep Street</b> <b>Bicester</b> <b>OX26 6TB</b>	<b>Licence Ref:</b>	PRM0233
	<b>Date Granted:</b>	21.04.2020
	<b>Valid to:</b>	Not Time Limited
	<b>Issue date:</b>	21.04.2020
	<b>Tel No.:</b>	

<b>Premises Licence Holder</b>	<b>Greene King Brewing And Retailing Limited</b> <b>Westgate Brewery</b> <b>Bury St Edmunds</b> <b>Suffolk</b> <b>IP33 1QT</b>
--------------------------------	--

### Licensable Activities - Alcohol Sales

Activity	Days of Week	Open	Close
<b>Sale of Alcohol</b> <b>Alcohol is supplied for consumption both on and off the Premises</b>	Thursday	10:00	02:00
<b>Sale of Alcohol</b> <b>Alcohol is supplied for consumption both on and off the Premises</b>	Sunday to Thursday	10:00	01:00
<b>Sale of Alcohol</b> <b>Alcohol is supplied for consumption both on and off the Premises</b>	Friday and Saturday	10:00	03:00

### Licensable Activities - Other

Activity	Days of Week	Open	Close
<b>Late Night Refreshment (Indoors)</b>	Sunday	23:00	01:00
<b>Late Night Refreshment (Indoors)</b>	Friday and Saturday	23:00	03:00
<b>Late Night Refreshment (Indoors)</b>	Monday to Thursday	23:00	02:00
<b>Regulated Entertainment (Indoors)</b>	Sunday	10:00	01:30
<b>Regulated Entertainment (Indoors)</b>	Friday and Saturday	10:00	03:30
<b>Regulated Entertainment (Indoors)</b>	Monday to Wednesday	10:00	01:00

### **Seasonal Variations**

**Late Night Refreshment** On St Davids Day, St Patricks Day, St Georges Day, St Andrews, Day the finish time will be extended by 1 hour, with 7 days notice and agreement with the Police.

For statutory Bank Holiday weekend periods (Friday, Saturday, Sunday and Monday) and for the Thursday before Good Friday and for Christmas Eve, the finish time will be extended by 1 hour beyond these times. On occasions of local, national or international significance or for charitable events, limited to 12 per year, the finish time will be extended by 1 hour, with 14 days notice and agreement with the Police.

**Regulated Entertainment** On St Davids Day, St Patricks Day, St Georges Day, St Andrews, Day the finish time will be extended by 1 hour, with 7 days notice and agreement with the Police.

For statutory Bank Holiday weekend periods (Friday, Saturday, Sunday and Monday) and for the Thursday before Good Friday and for Christmas Eve, the finish time will be extended by 1 hour beyond these times. On occasions of local, national or international significance or for charitable events, limited to 12 per year, the finish time will be extended by 1 hour, with 14 days notice and agreement with the Police.

**Sale of Alcohol** On St Davids Day, St Patricks Day, St Georges Day, St Andrews Day the finish time will be extended by 1 hour, with 7 days notice and agreement with the Police.

For statutory Bank Holiday weekend periods (Friday, Saturday, Sunday and Monday) and for the Thursday before Good Friday and for Christmas Eve, the finish time will be extended by 1 hour beyond these times. On occasions of local, national or international significance or for charitable events, limited to 12 per year, the finish time will be extended by 1 hour, with 14 days notice and agreement with the Police.

New Years Eve from the end of permitted hours on New Years Eve to the start of permitted hours on the following day (or, if there are no permitted hours on the following day, midnight on 31 December)

### **Opening Hours**

<b>Days of Week</b>	<b>Open</b>	<b>Close</b>
Friday and Saturday	09:00	03:30
Monday to Wednesday	09:00	02:00
Thursday	09:00	02:30
Sunday	09:00	01:30

### **Seasonal Variations**

On St Davids Day, St Patricks Day, St Georges Day, St Andrews, Day the finish time will be extended by 1 hour, with 7 days notice and agreement with the Police.

For statutory Bank Holiday weekend periods (Friday, Saturday, Sunday and Monday) and for the Thursday before Good Friday and for Christmas Eve, the finish time will be extended by 1 hour beyond these times. On occasions of local, national or international significance or for charitable events, limited to 12 per year, the finish time will be extended by 1 hour, with 14 days notice and agreement with the Police.

**Registered number of holder, for example company number, charity number**

Registered Company Number 03298903

**Name of designated premises supervisor where the premises licence authorises for the supply of alcohol**

Mr John O'Leary

**State whether access to the premises by children is restricted or prohibited**

Not Specified



Michael Sands  
Licensing Officer  
21 April 2020